

JB100 Series

Triple Axis Joystick Controller (Potentiometer)



- Triple Axis
- Vertical Z Axis with Spring Return
- ‘Guided Feel’, X and Y Axis
- Center Tap Option
- 5 mio. Operations (X,Y Axis)
- 2 mio. Operations (Z Axis)
-  **RoHS**

Electrical Data (Note 1)

Electrical Travel	X and Y Axis: 40° ($\pm 20^\circ$ from center) Z Axis: 30° ($\pm 15^\circ$ from center) Potentiometer inside knob
Resistance Value	10k Ω $\pm 15\%$ (X, Y and Z axis)
Independent Linearity Tolerance	$\pm 3\%$
Resolution	Infinite
Output Smoothness	< 0.2% against applied voltage
Contact Resistance Variation	< 5% C.R.V.
Dielectric Strength	500VAC, 1 minute
Insulation Resistance	> 1000M Ω at 500VDC
Rated Power	0.13W X, Y Axis (0.1W Z Axis)

• Special Specifications Available

Special resistance values, center tap potentiometers, custom cabling, spring return to end on Z axis, other customization to suit.

Note 1: Customers should test and verify device performance in any given application. Specifications are subject to change without notice.

JB100 Series

Triple Axis Joystick Controller (Potentiometer)



Mechanical Data (Note 1)	
Mechanical Travel	X, Y Axes: approx. $\pm 20^\circ \sim \pm 25^\circ$ from center Z Axis: approx. $\pm 15^\circ \sim \pm 19^\circ$ from center
Operating Force	X, Y, Axes: 0.8 ~ 2.3N (two springs, guided feel) X, Y Axes: 24 ~ 30mN · m
Operating Temperature	-20°C ~ +65°C
Vibration	10 ~ 55Hz 98m/s ² (10G)
Shock	30G
Life Expectancy	> 5,000,000 operations (> 2,000,000 Z Axis)
Protection Grade	IP40
Weight	approx. 410g

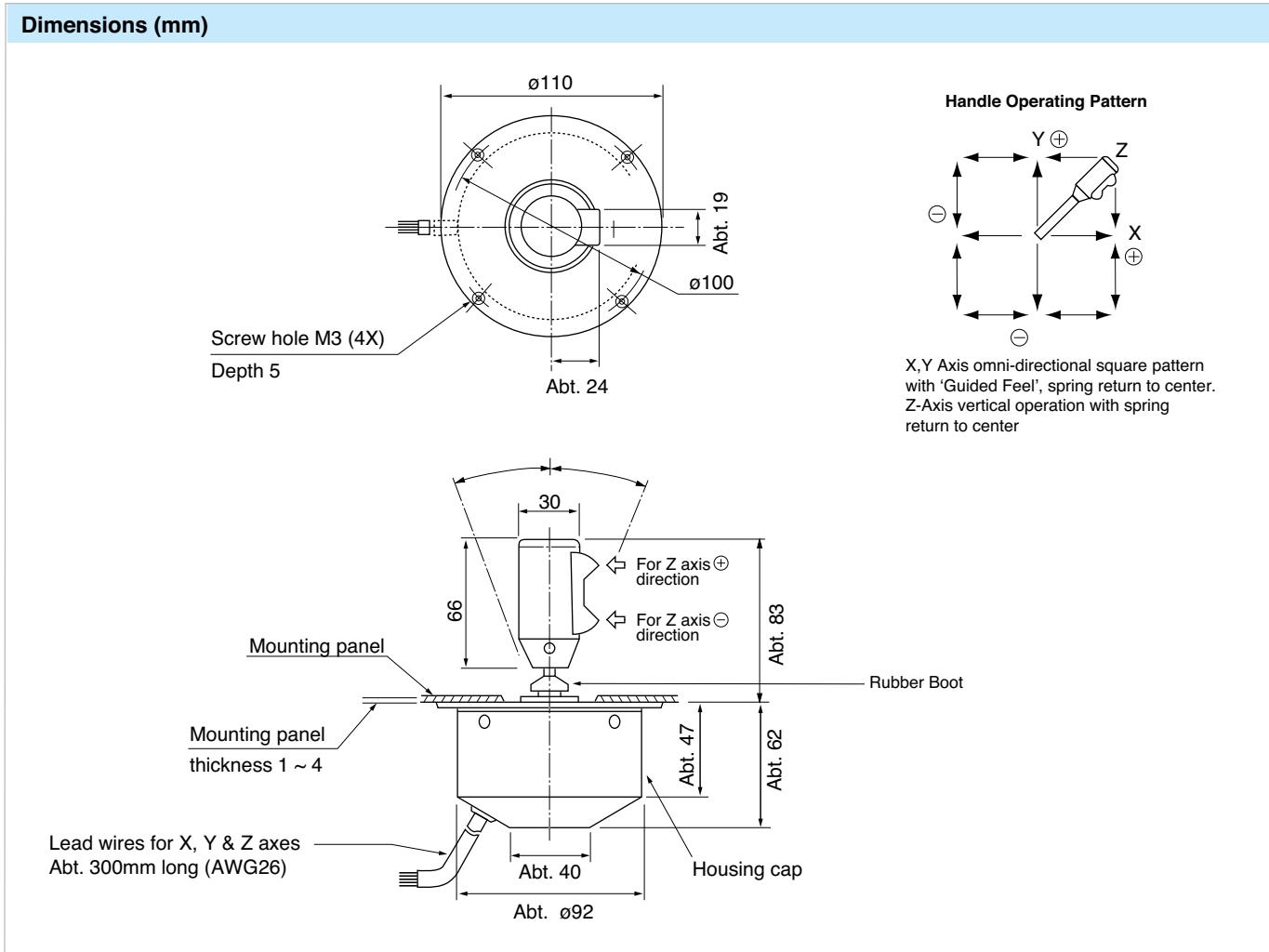

JB100 Series

Triple Axis Joystick Controller (Potentiometer)

Mounting Details

Panel Arrangements

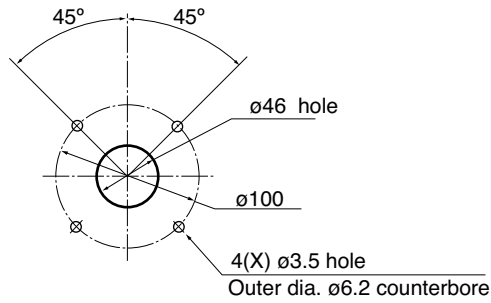

Dimensions (mm)

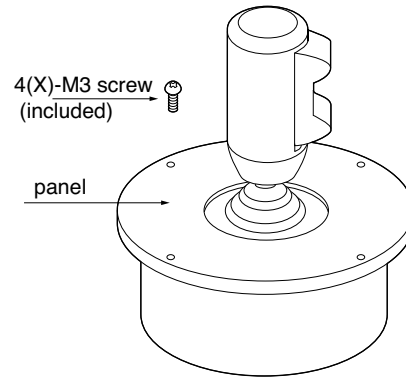

X, Y & Z Axis Potentiometer Schematic

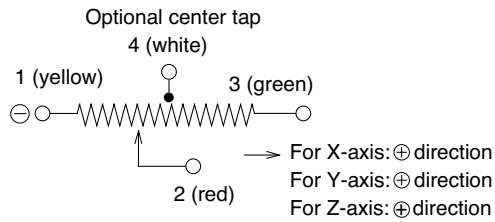

Terminals shall be leadwires, approx. 300mm length, AWG26