

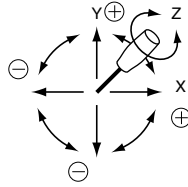

JH30 Series

Triple Axis Joystick Controller (Potentiometer)



- Triple Axis
- Spring Return to Center
- $\pm 15^\circ$ X, Y Axis Travel
- $\pm 30^\circ$ Z Axis Travel
- IP65 Protection Grade
- > 2 mio. operations life
-  RoHS

Electrical Data (Note 1)	
Electrical Travel	X, Y Axis: approx. 25° ($\pm 12.5^\circ$ from center) Z Axis: approx. 60° ($\pm 30^\circ$ from center)
Resistance Value	10k Ω $\pm 20\%$ (other resistance values optional)
Independent Linearity Tolerance	$\pm 5\%$
Output Smoothness	< 0.2% against input voltage
Contact Resistance Variation	< 6% C.R.V.
Resolution	Infinite
Power Rating	X, Y Axis Potentiometers: 0.1W Z Axis Potentiometer: 0.4W
Insulation Resistance	> 1000M Ω at 500VDC
Dielectric Strength	500VAC, 1 minute

Mechanical Data (Note 1)	
Mechanical Travel	X, Y Axis: $\pm 10^\circ \sim \pm 15^\circ$ from center Z Axis: $\pm 30^\circ \sim \pm 35^\circ$ from center
Operating Force	X, Y Axis: 1 ~ 2N (100 ~ 200gf) Z Axis: 30 ~ 70mN·m (300 ~ 700gf·cm)
Center Return Accuracy	50% $\pm 5\%$
Operating Temperature	$-20^\circ\text{C} \sim +65^\circ\text{C}$
Vibration	10 ~ 55Hz 98m/s ² (10G)
Shock	30G
Life Expectancy	> 2,000,000 random operations
Protection Grade	IP65
Weight	approx. 130g

• Special Specifications Available

Center tap of potentiometers, special resistance value, Z axis switch function, other customization to suit.

Note 1: Customers should test and verify device performance in any given application. Specifications are subject to change without notice.

JH30 Series

Triple Axis Joystick Controller (Potentiometer)

Dimensions (mm) / Electrical Schematic

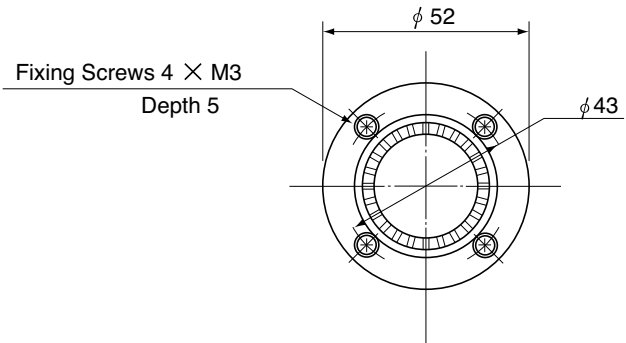
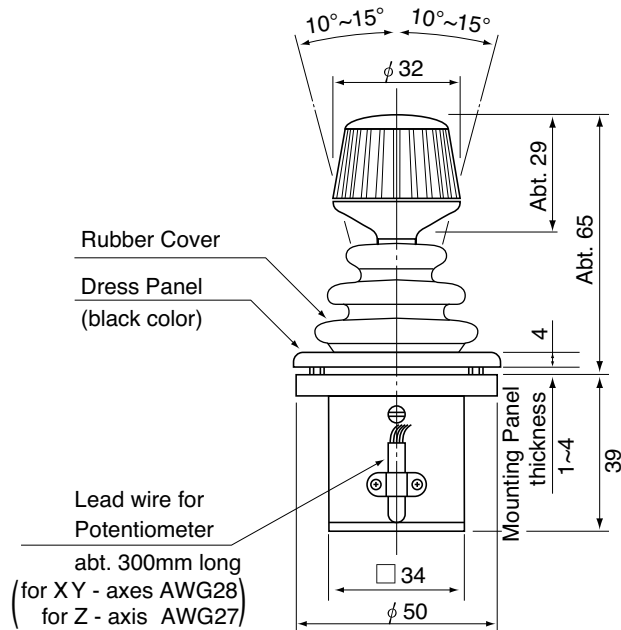

Electrical Schematic / Terminations

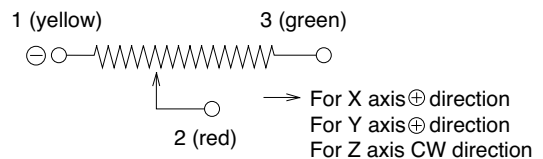

Mounting Details

Panel Arrangements

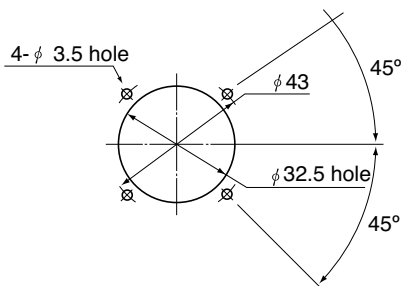

1. 4 pcs. mounting screws (M3 X 8) attached.
2. Fastening torque of screws shall be below 400mN·m (4kgf·cm)

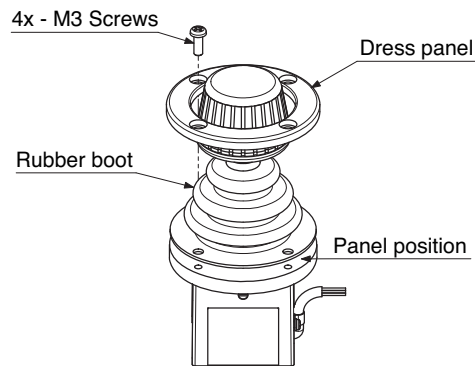

- (1) Remove 4 screws from the dress panel.
- (2) Put the joystick from the below your panel as shown on the sketch.
- (3) Assemble the dust-proof rubber cover and the dress panel, and fix them with 4 screws.

Mounting Plate (optional)

