

# JW30 Series

## Single Axis Joystick Controller (Potentiometer, Thumb Controller)



- Single Axis
- 30° Electrical Travel
- Spring Return to Center
- Variety of Knob Shapes
- Infinite Resolution
- Conductive Plastic Element

▪  **RoHS**

Electrical Data (Note 1)	
Electrical Travel	30° (±5°)
Standard Resistance Values	10k Ω
Non-Standard Resistance Values Options	1k, 2k, 5k, 20k Ω
Resistance Tolerance	±5%
Independent Linearity	±1%
Output Smoothness	< 0.2% against input voltage
Contact Resistance Variation	< 5% C.R.V.
Resolution	Infinite
Center Return Accuracy	50% ±3%
Power Rating	0.1W
Resistance Temperature Coefficient	±400p.p.m/°C
Insulation Resistance	> 1,000MΩ at 500VDC
Dielectric Strength	1 minute at 500VAC

Mechanical Data (Note 1)	
Mechanical Travel	±15° ~ ±19° from center position
Operating Force	Approx. 24mN • m ~ 30mN • m (D type knob; 49mN • m ~ 60mN • m)
Operating Temperature	-20°C ~ +60°C
Vibration	10G 10 to 55Hz
Shock	30G
Life Expectancy	> 2,000,000 random operations
Protection Grade	IP40 (IP54 option)
Weight	Approx. 20g

### • Special Specifications Available

Extra tap (1 maximum), heavier operating force (except for D type knob), custom knob shapes, IP54 protection grade

Note 1: Customers should test and verify device performance in any given application. Specifications are subject to change without notice.

# JW30 Series

## Single Axis Joystick Controller (Potentiometer, Thumb Controller)

### Dimensions (mm)

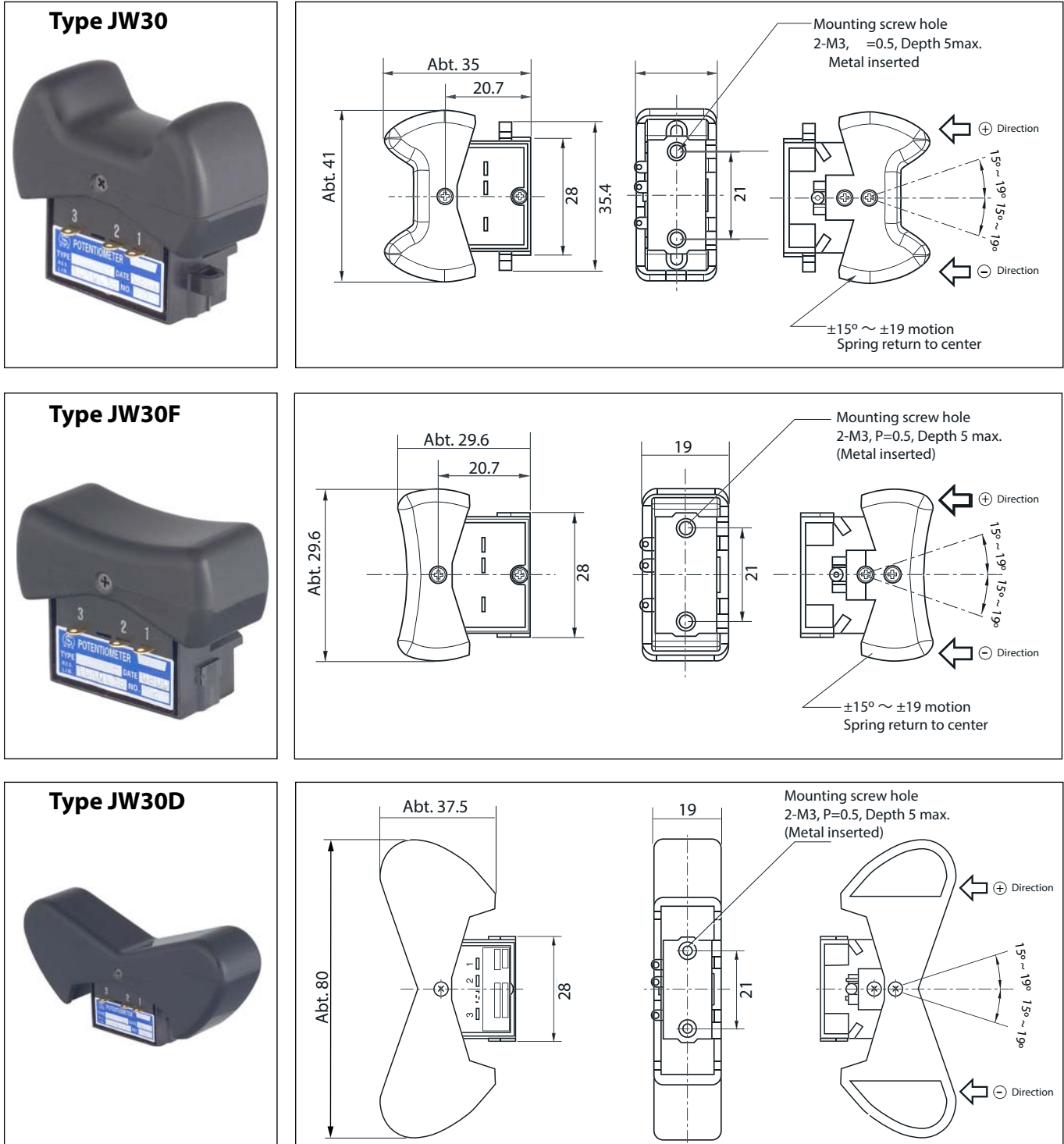

# JW30 Series

## Single Axis Joystick Controller (Potentiometer, Thumb Controller)

### Electrical Characteristics

