



- Strain gauge principle
- Aluminium alloy
- Force transmission via M12-thread for 50N..1kN
- Protection grade IP54
- Easy to install, stable and reliable

Series KM1403 force transducer is a all-purpose S-beam load cell. Suitable for batching systems, industrial scales and package systems, etc.

Data Load Cell

Rated force	50N, 200N, 100N, 500N, 1kN
Rated characteristic value	2,0 mV/V @ rated force
Relative error of characteristic value	≤ 1 % of F.S.
Relative repeatability error	≤ 0.03 % of F.S.
Relative reversibility error	≤ 0.03 % of F.S.
Relative linearity error	≤ 0.03 % of F.S.
Relative deviation of zero signal	≤ 3 % of F.S.
Rated displacement	≤ 0,3 mm
Input resistance	410 ±5 Ω
Output resistance	350 ±3 Ω
Insulation resistance	≥ 5 GΩ @ 50 VDC
Maximum operating force	≤ 150% of rated force
Rated range of excitation voltage	≤ 10 V DC/AC
Operating range of excitation voltage	≤ 15 V DC/AC
Rated temperature range	-10 °C..+40 °C
Operating temperature range	-10 °C..+70 °C
Protection	IP54
Temperature effect on characteristic value	≤ 0,02 %/10 K of F.S.
Temperature effect on zero signal	≤ 0,02 %/10 K of F.S.
Creep under load	≤ 0.03% of F.S. after 0.5 h @ rated force
Cable dimension	4xAWG24; jacket Ø4,8 mm; screened
Cable length from body	ca. 6 m
Body material / cable material	Aluminium alloy / UL-PVC

S-Beam Load Cells
Series KM1403
Order code
Description

Selection: standard=black/bold, possible options=grey/cursive

Series:
KM1403
**Connecting cable:
Cable length 6 m**
K
Rated force:
Option 50N

50N

Option 100N

100N

Option 200N

200N

Option 500N

500N

Option 1kN

1kN

Accessories
Measuring amplifier

IMA2 DMS

Drawing

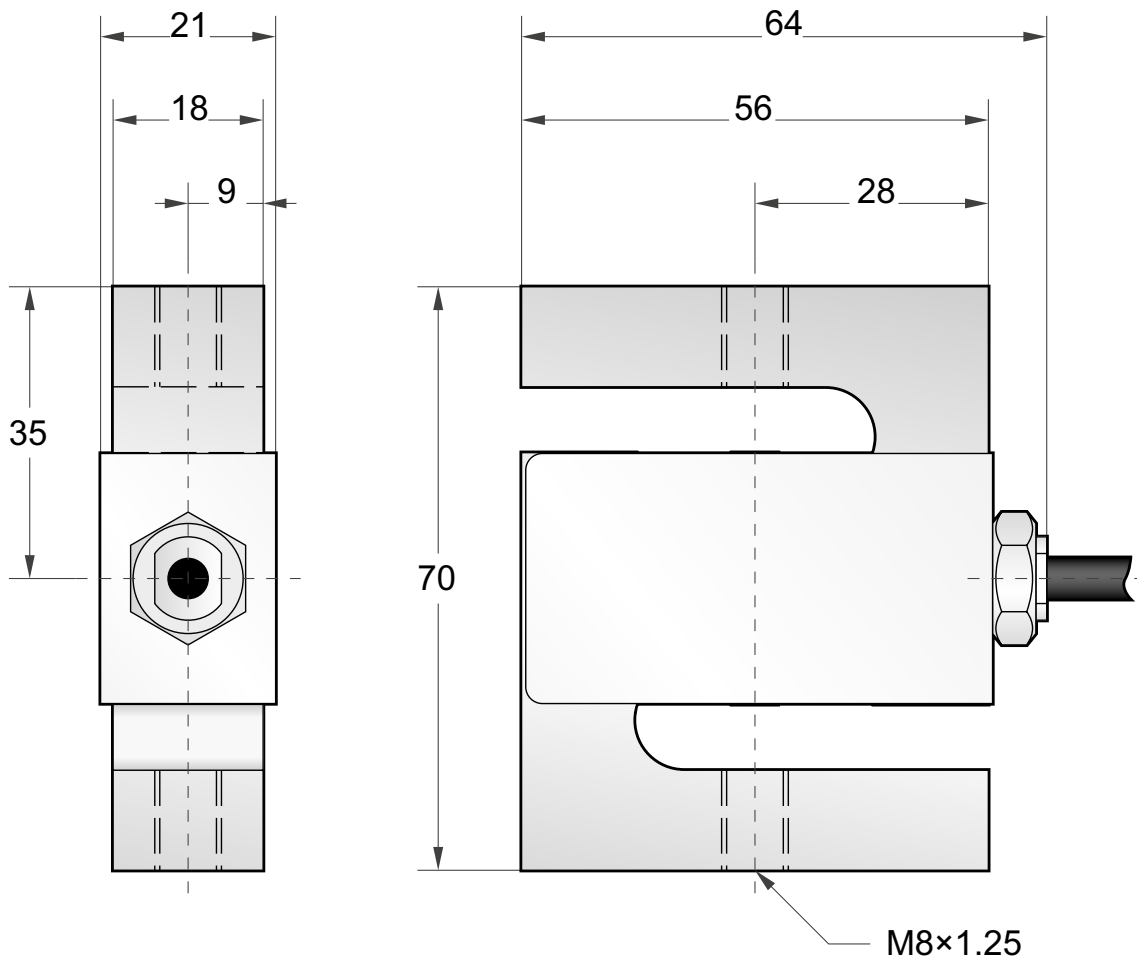

Dimensions in mm

Cable assignment

For tension:

- Red: +input
- Black: -input
- White: -output
- Green: +output

For pressure:

- Red: +input
- Black: -input
- White: +output
- Green: -output

**Connection diagram
tension**

