

Linear Motion Conductive Plastic Potentiometer
Series LMC15

- Front and Rear Shaft
- 10, 15, 20 and 30mm Stroke Lengths
- Spring Return Option (spring internal)
- 20,000,000 Stroke Life
- Infinite Resolution
-  RoHS

Electrical Data (Note 1)	Model	LMC15-10	LMC15-15	LMC15-20	LMC15-30
Electrical Stroke		10±0.5mm	15±0.5mm	20±0.5mm	30±0.5mm
Standard Resistance Values		500,1k, 2k, 5k, 10k Ω			
Resistance Tolerance		±10%			
Independent Linearity Tolerance (standard)		±2.0%	±1.0%		
Independent Linearity Tolerance (optional)		±1.0%	±0.5%		
Power Rating @ 70°C		0.2W	0.3W	0.4W	0.5W
Resolution		Essentially infinite			
Output Smoothness		< 0.1% against input voltage			
Resistance Temperature Coefficient		±400 p.p.m/°C			
Insulation Resistance		> 1,000M Ω at 500VDC			
Dielectric Strength		1 minute at 1,000VAC			

Mechanical Data (Note 1)	Model	LMC15-10	LMC15-15	LMC15-20	LMC15-30
Mechanical Stroke		10 ⁺² ₀ mm	15 ⁺² ₀ mm	20 ⁺² ₀ mm	30 ⁺² ₀ mm
Life Expectancy		20,000,000 reciprocating motions			
Friction (without spring)		< 0.3N (30gf)			
Friction (with spring, LMCR)		< 3.0N (300gf)			
Stopper Strength		Approx. 20N (2kgf)			
Operating Temperature		-30°C to +105°C			
Vibration		15G / 10Hz to 2,000Hz 12 hours			
Shock		50G, 11ms 18 times			
Protection Grade		IP40 (IP54 option)			
Housing Material		Plastic			
Shaft Material		Stainless steel			
Weight		approx. 30g			

Special Specifications Available

Special shaft machining, non-standard resistance values, custom cabling, IP54 sealing (friction increases)

Note 1: Customers should test and verify device performance in any given application. General specifications values are measured at temperatures of +15°C ~ +35°C. Specifications are subject to change without notice.

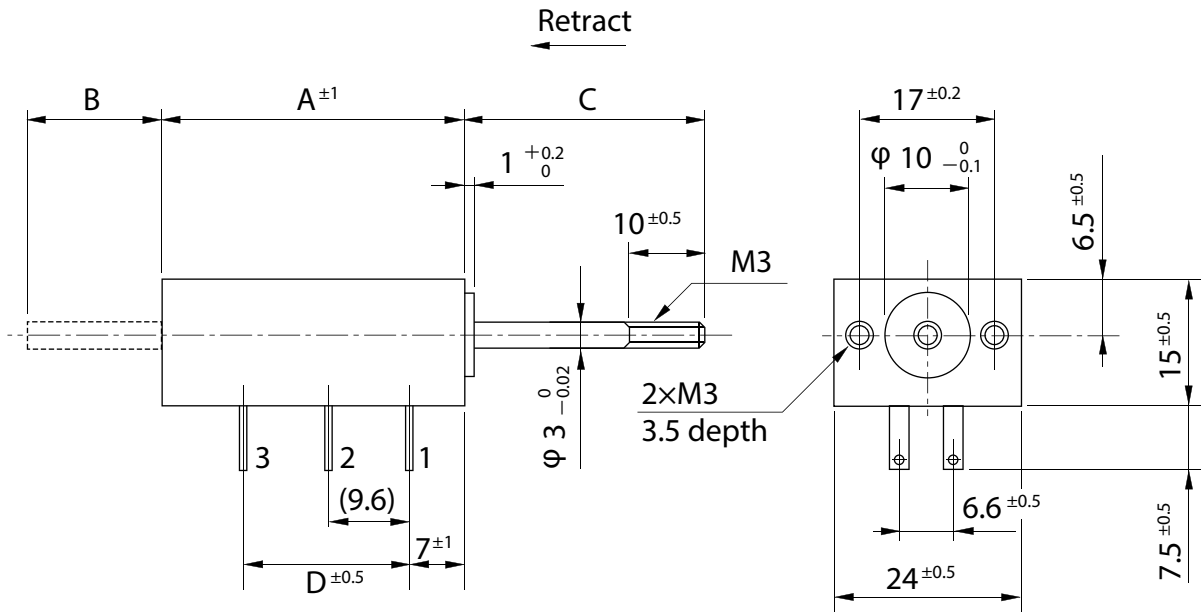

Model	Dimension A		B		C		D
	Retracted	Extended	Retracted	Extended	Retracted	Extended	
LMC(R)15-10	37	11	0	15	26	20	
LMC(R)15-15	37	16	0	15	31	20	
LMC(R)15-20	52	21	0	15	36	35	
LMC(R)15-30	52	31	0	15	46	35	

