

SLPIS

Linear Potentiometer 10 - 100 mm

Slim Body Series

Internal Spring Return, Rod On The Both Sides

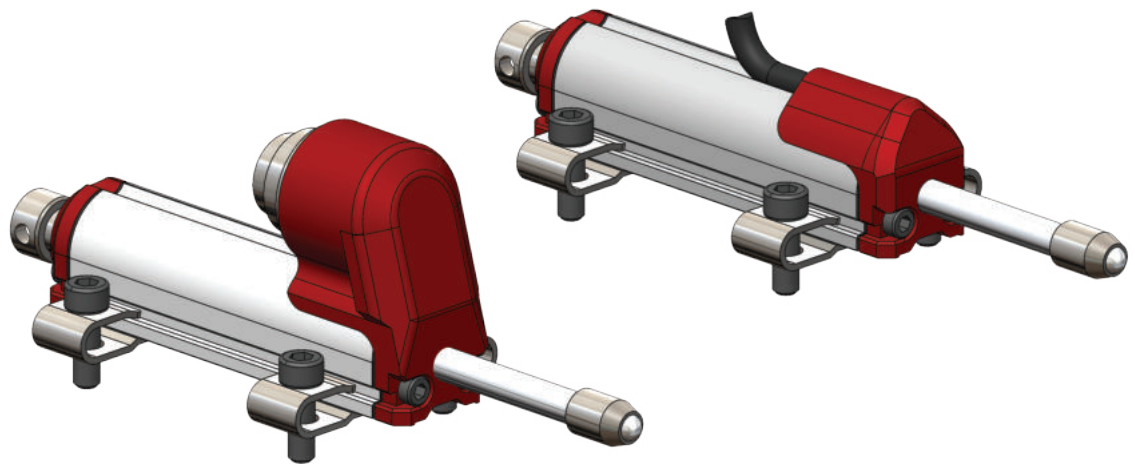

1. TECHNICAL SPECIFICATIONS

Measurement stroke	10 - 100 mm
Repeatability	< 0.002 mm
Resolution	Infinite
Permissible applied voltage	28 VDC max.
Electrical connections	Cable output (standard) CN5B: M16, 5 pin connector output (optional)
Displacement speed	< 5 m/s
Mechanical life	100 million movement
Protection level	IP 40
Resistance	2 kOhm: 10 - 50 mm 5 kOhm: 75 - 100 mm
Resistance tolerance	± %20
Load resistance	100 kOhm min.
Recommended wiper current	<1 µA
Linearity	A: ±%0.5 (≤75 mm) B: ±%0.2 (100 mm)
Case dimensions	Ø18 mm
Case material	Anodized aluminium
Caps material	ABS Plastic
Rod material	Stainless steel
Rod diameter	Ø5 mm
Mechanical fixing	Variable brackets
Operating temperature	-20°C ... +80°C
Storage temperature	-30°C ... +90°C

2.MECHANICAL SPECIFICATIONS

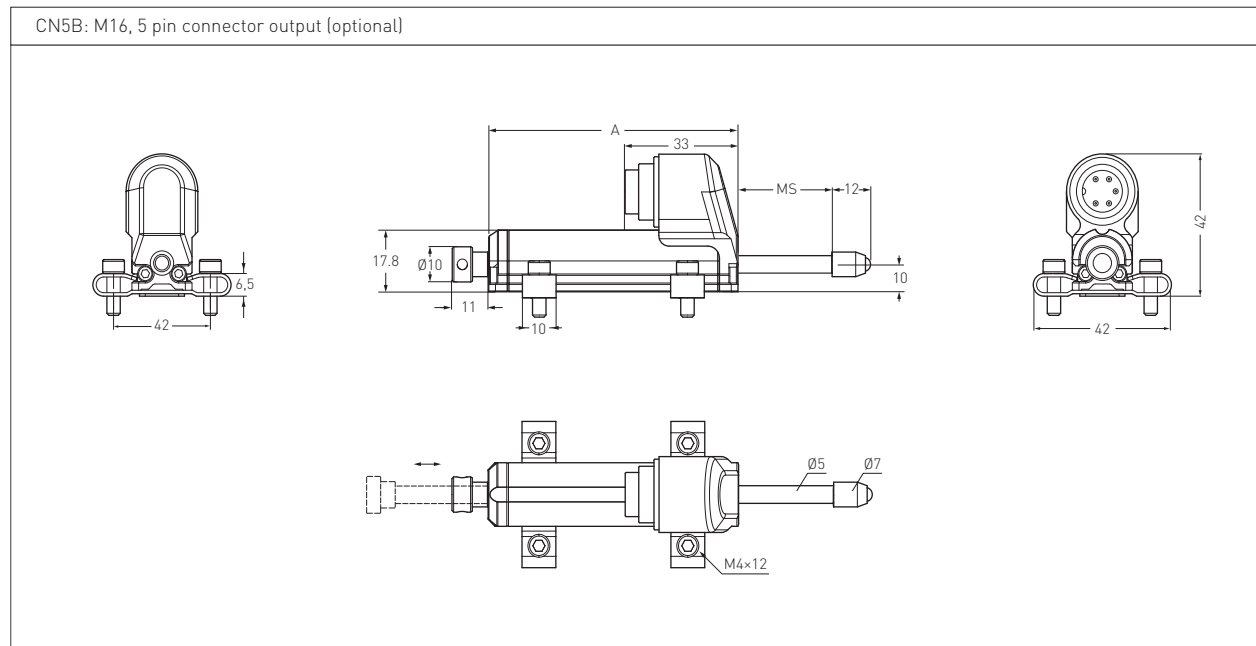
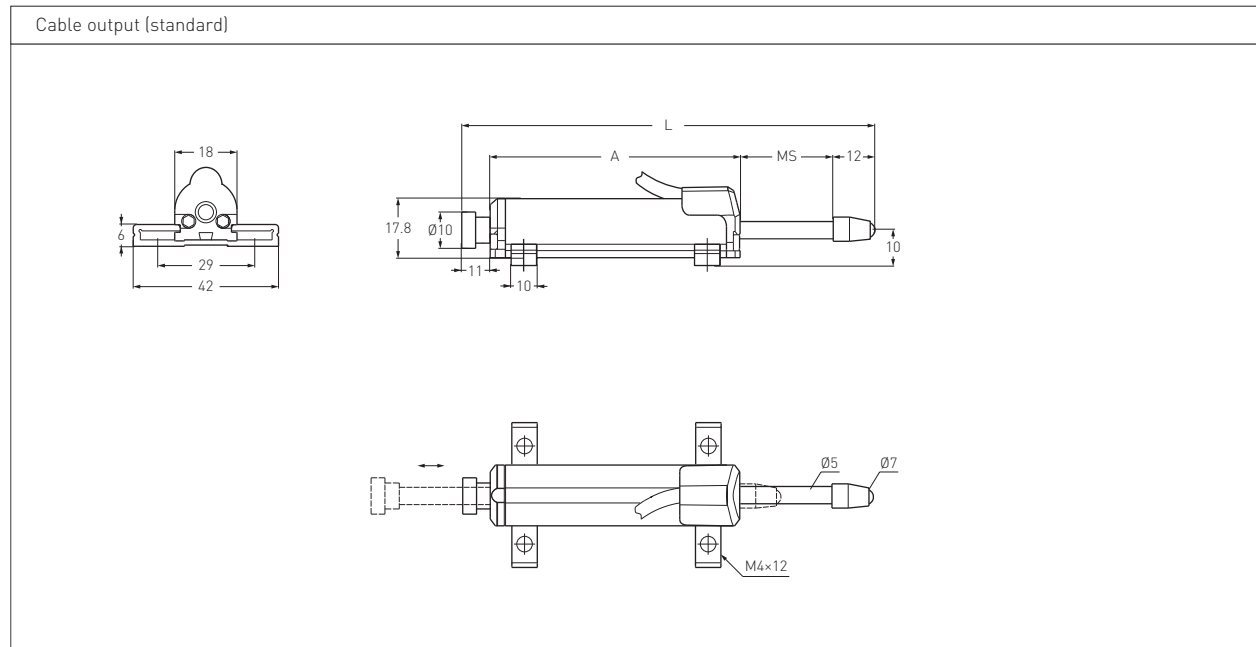

SLPIS (mm)	10	25	50	75	100
US (Usefull stroke)	10	25	50	75	100
MS \pm 0.5 (Mechanical stroke)	13	28	53	78	103
A \pm 0.5	59	74	105	132	164
L (Total length)	95	125	181	233	290

3.CABLE, CONNECTOR AND BRACKET

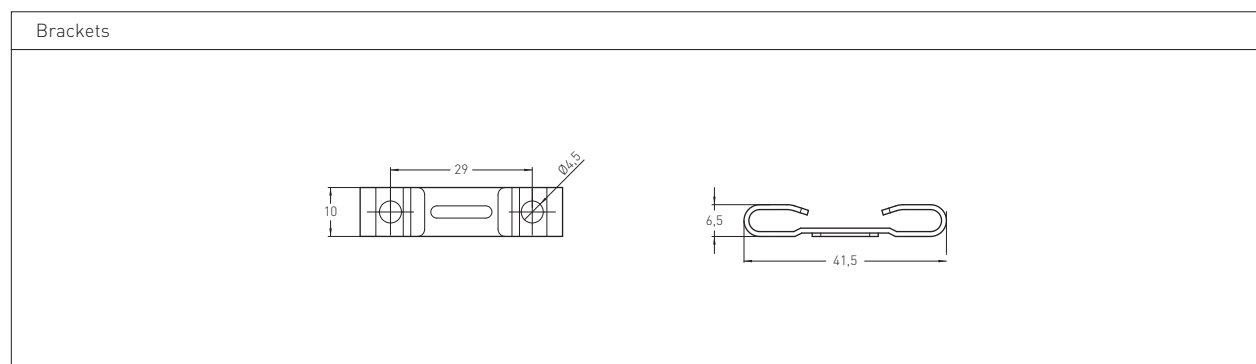
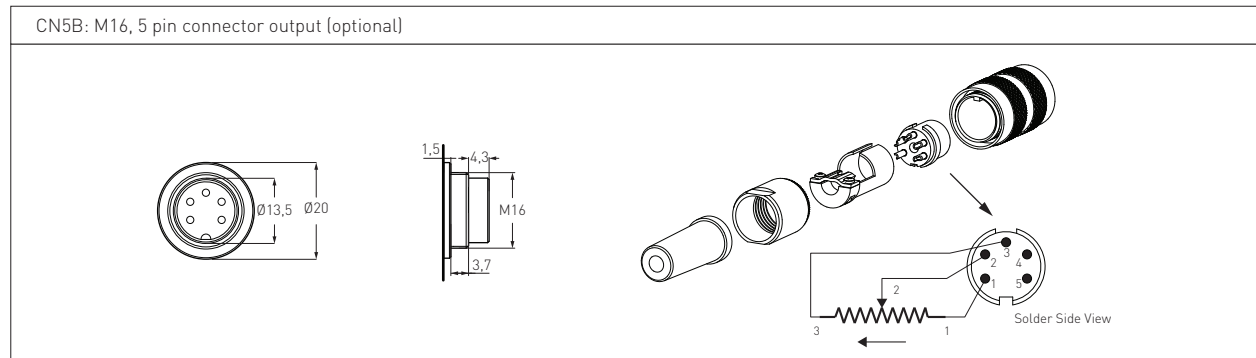
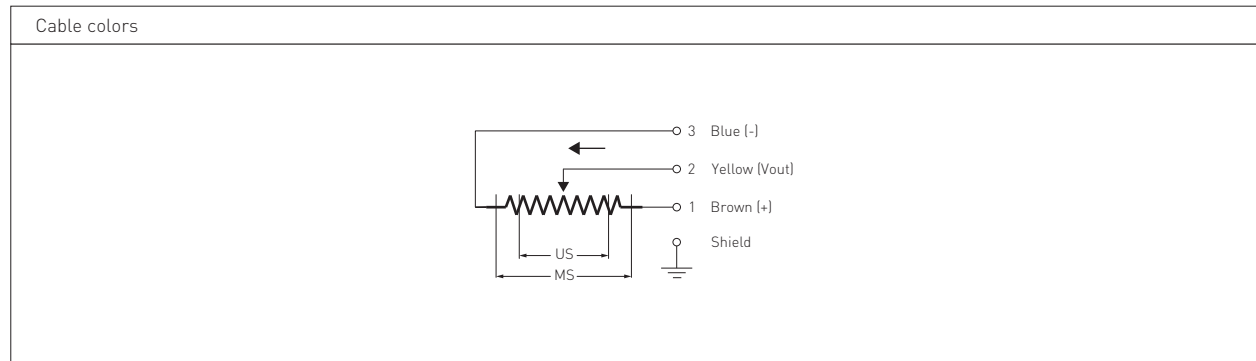

4.ASSEMBLY

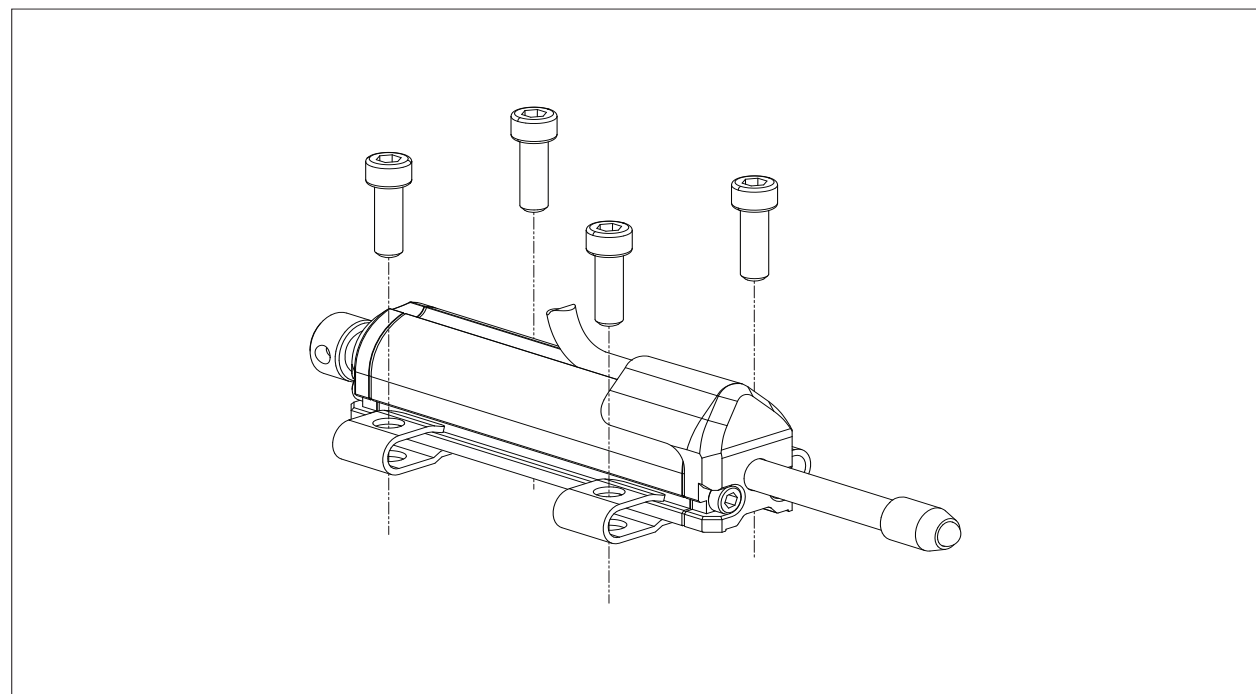

5.ORDERING PRODECURE

1	Model
	SLPIS: Linear Potentiometer Slim Body Series, Internal Spring Return
2	Measurement stroke
	10 - 100 mm
3	Linearity
	A: ± 0.5 (≤ 75 mm) B: ± 0.2 (100 mm)
4	Resistance (kOhm)
	2K: 5 kOhm (10 - 50 mm) 5K: 10 kOhm (75 - 100 mm)
5	Cable / Connector
	1M: 1 meter cable (standard) CN5B: M16, 5 pin connector (optional)

For example:

1	2	3	4	5
SLPIS	25	B	5K	1M