

# STCS40 Series

## Single Turn Potentiometer (Conductive Plastic)

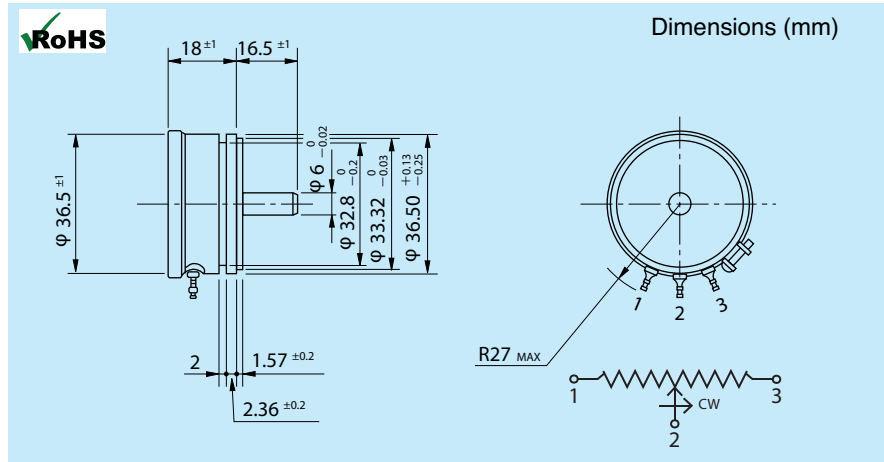

### • General Specifications (Note 1)

<b>Resistance Values (<math>\Omega</math>):</b>	500, 1K, 2K, 5K, 10K, 20K 50K, 100K, 200K	<b>Contact Resistance Variation:</b>	Below 2% C.R.V.
<b>Resistance Tolerance:</b>	Standard Class $\pm 10\%$ Precision Class $\pm 5\%$	<b>Power Rating:</b>	2.0W @ 70°C (0W @ 105°C)
<b>Independent Linearity Tolerance:</b>	Standard Class $\pm 0.5\%$ Precision Class $\pm 0.25\%$ Super Precision Class $\pm 0.1\%$	<b>Electrical Travel:</b>	340° $\pm 5^\circ$
<b>Resolution:</b>	Essentially Infinite	<b>Mechanical Travel:</b>	360° (continuous)
<b>Output Smoothness:</b>	Below 0.1% against input voltage	<b>Insulation Resistance:</b>	> 1000M ohms @ 500 VDC
<b>Rotational Life:</b>	50,000,000 shaft revolutions (no load)	<b>Dielectric Strength:</b>	1 minute @ 500 VAC
<b>Protection Grade:</b>	IP40	<b>Starting Torque:</b>	< 3mN·m (30gf·cm)
<b>Operating Temperature:</b>	-55°C ~ +125°C (Note 1)	<b>Temperature Coefficient:</b>	$\pm 400$ p.p.m / °C
		<b>Vibration:</b>	15G / 10Hz to 2,000Hz
		<b>Shock:</b>	50 G / 11ms
		<b>Mass:</b>	Approx 60g

### • Special Specifications Available

Extra taps (Available up to 3 taps). Multi-ganged (up to 7 gangs, housing length extended by 12mm per gang). Shaft with front and rear extension (rear shaft with 6mm dia. and 15mm length). With stopper (angle becomes 320° and stopper strength is 0.9N·m [9kgf · cm]). Special electrical angles. Shaft with  $\phi 6.35$ mm. Special machining on shaft.

Note 1: Customers should test and verify device performance in any given application. General specifications are measured at temperatures of +15°C ~ +35°C. Specifications subject to change without notice.